

LUBRICATE ALL SEALS WITH CLEAN HYDRAULIC OIL PRIOR TO ASSEMBLY. DO NOT USE SILICONE BASED LUBRICANTS.

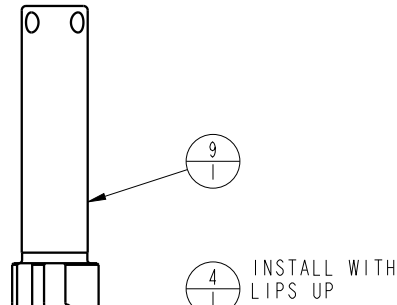

COAT WITH LITHIUM GREASE

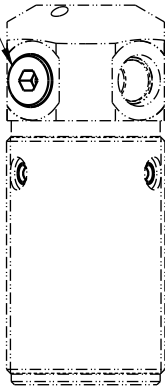
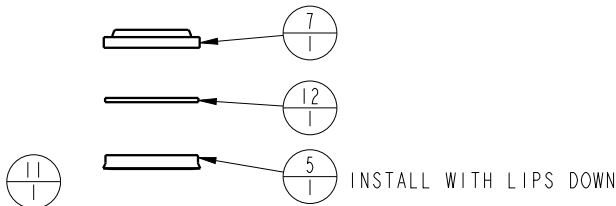
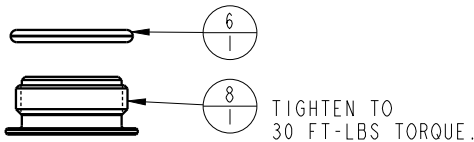
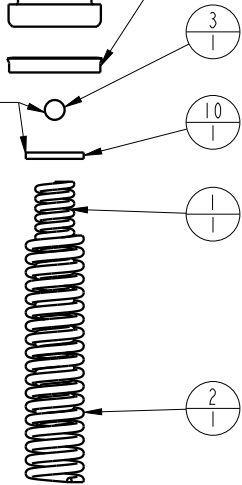

N/A	N/A	61250000	KIT, SPRING	N/A	N/A	NOTED
N/A	N/A	6V250109	KIT, SEAL, FKM	N/A	NOTED	N/A
N/A	N/A	60250109	KIT, SEAL, STANDARD	NOTED	N/A	N/A
12	1	39F54001	BU RING, (-208 CUSTOM)	X	X	
11	1	92090001	ASSY, BREATHER, SAE #4			
10	1	81590901	DISK, PIVOT, BALL, SC, 1100, SA			X
9	1	81510901	PLUNGER, SC, 1100#			
8	1	81400029	RETAINER, SC, HS, 1100			
7	1	39053001	WIPER, SNAP-IN, (5/8)	X	X	
6	1	39051031	O-RING, (-912)	X	X	
5	1	39010020	SEAL, BEVEL W/HEEL INSERT, 5/8 x 1/8 x 7/8	X	39V10020	
4	1	39010015	SEAL, BEVEL, 11/16 x 3/32 x 7/8	X	39052011	
3	1	23600011	BALL, STEEL, ALLOY, .187			X
2	1	23313008	SPRING, COMPRESSION			X
1	1	23311013	SPRING, COMPRESSION			X
No.	QTY	PART No.	DESCRIPTION	STANDARD SEAL KIT	FKM SEAL KIT	SPRING KIT

PARTS LIST



VEKTEK, INC.
1334 E. SIXTH AVE. P.O. BOX 625
EMPORIA, KS. 66801 U.S.A.

ASSEMBLIES AFFECTED
25010909
25010909F

PARTS LIST, ASSY, CYL, PULL, TB, 1400

SIZE A PL2515

REV B

B	5481	RELEASE	JDW	08/12/24
REV	IN ACCORDANCE WITH ECN	EFFECTIVE DATE	REVISED BY	DATE
DRW BY:	NPETERS	DRAWING STATUS: Released		
DATE:	5/13/21	PRODUCTION APPROVED FOR RELEASED STATUS ONLY		

FORM FEG035_PL_ASIZE, REV. B

SHEET 1 OF 1